



193a London Road, Chippenham, SN15 3AW

£279,950

Located on the outskirts of Central Chippenham, within easy reach of the town centre, a two bedroom semi detached bungalow with additional reception to main living room providing a useful space for study / office. To the rear there is an enclosed garden laid mainly to lawn and to the front there is a further area of garden. The property benefits from double glazing and gas central heating.

Entrance Hallway



Front door leads into hallway, radiator, access to loft.

Living Room 11'11" into alcove x 11'07"
(3.63m into alcove x 3.53m)



Double glazed bay front window, fireplace, radiator.



Fitted Kitchen 11'11" x 9'0" (3.63m x 2.74m)



Two double glazed windows, work tops with a range of cupboards and drawers, inset sink unit, space for cooker, plumbing and space for washing machine, wall mounted gas boiler, radiator.

Reception Two 14'03" x 8'05" (4.34m x 2.57m)



Three double glazed windows, door to garden, radiator.

Bedroom One 11'07" x 10'09" (3.53m x 3.28m)



Double glazed window, radiator.

Bedroom Two 9'09" x 8'10" (2.97m x 2.69m)



Double glazed window, radiator.

Bathroom

Double glazed window, tiled shower cubicle, hand basin, W.C, radiator.

Outside

Rear



To the rear of the property there is an enclosed garden laid mainly to lawn with side access to the front.



Front



To the front there is a further area of garden.



Tenure

GOV.UK advise Freehold.

Council Tax Band

To Be Confirmed.

Floor Plan

715 sq.ft. (66.4 sq.m.) approx.

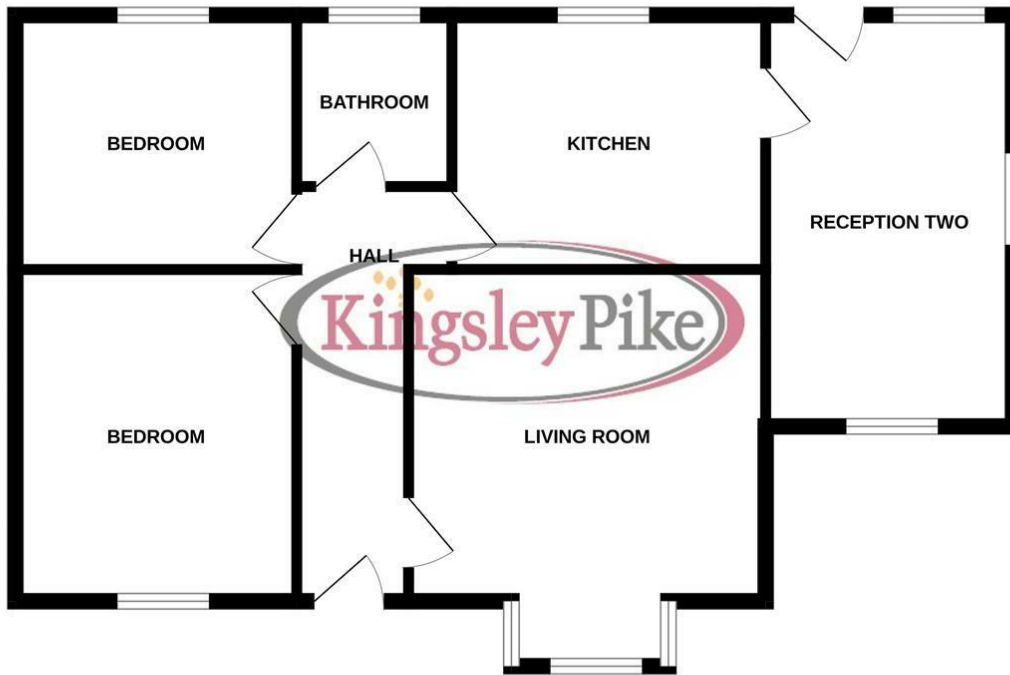

TOTAL FLOOR AREA : 715 sq.ft. (66.4 sq.m.) approx.

Whilst every attempt has been made to ensure the accuracy of the floorplan contained here, measurements of doors, windows, rooms and any other items are approximate and no responsibility is taken for any error, omission or mis-statement. This plan is for illustrative purposes only and should be used as such by any prospective purchaser. The services, systems and appliances shown have not been tested and no guarantee as to their operability or efficiency can be given.
Made with Metropix ©2026

Area Map



Energy Efficiency Graph

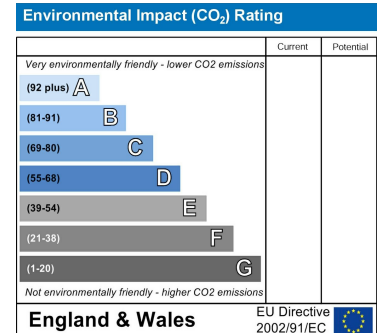
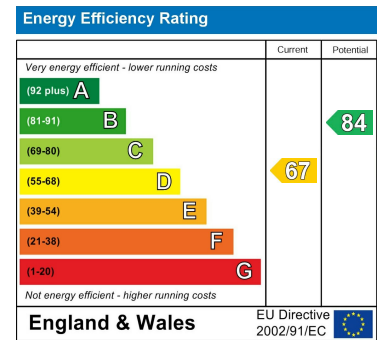

These particulars, whilst believed to be accurate are set out as a general outline only for guidance and do not constitute any part of an offer or contract. Intending purchasers should not rely on them as statements of representation of fact, but must satisfy themselves by inspection or otherwise as to their accuracy. No person in this firm's employment has the authority to make or give any representation or warranty in respect of the property.

63 New Road, Chippenham, Wiltshire, SN15 1ES
Tel: 01249 464844 Email: sales@kingsleypike.co.uk <https://www.kingsleypike.co.uk>